

# Switch Position Indicators for direct current or alternating current 45 ... 65 Hz

## Specifications

### Front frame black

front dimensions type	25 x 25 Stg 1	Ø 25 St 1	Ø 32 <sup>1)</sup> St 2
weight kg approx.	0.07	0.07	0.07
nominal insulation voltage	250 V	250 V	250 V
protection of front side	IP 52	IP 52	IP 52
fixing	ring nut	ring nut	ring nut

<sup>1)</sup> comes with plug-on type front frame (36 x 36 mm)

### Connection voltage

#### direct current

24 V (0.3 W)  
60 V (0.4 W)  
110 V (0.6 W)  
220 V (1.0 W)

#### alternating current 45 ... 65 Hz

24 V (0.3 VA)  
60 V (0.4 VA)  
110 V (0.6 VA)  
220 V (1.2 VA)

## Description

Switch position indicators for electrical remote indication of switch positions in plants and switching stations.  
Furthermore they can be used as target indicators in mimic diagrams.

## Display

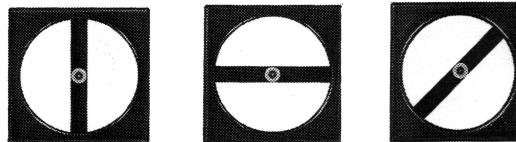

The display can show the following three states:  
"on", "off" and "error"  
or "disabled".

## Mechanical Setup

### housing material

polycarbonate, self-extinguishing (UL 94 V-2)

### connection terminals

flat plug 2.8 x 0.8 mm

### finger contact protection

available as option

## Basic dimensions

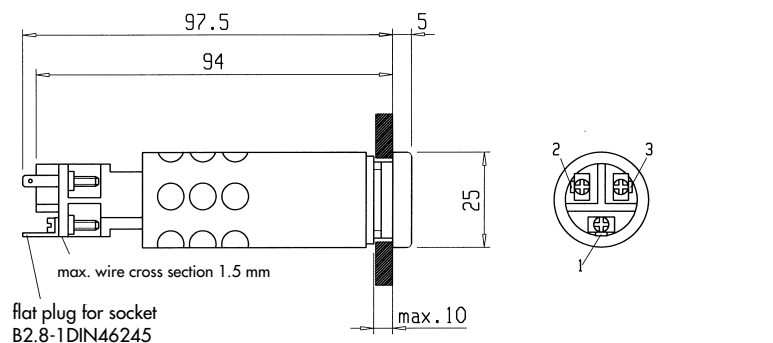

## Front dimensions

